

# PERFECTLY POSITIONED

EASTWELL MANOR, PERFECTLY POSITIONED – ONLY 38 MINUTES FROM THE BUZZ OF LONDON ST. PANCRAS, SET IN THE HEART OF THE GARDEN OF ENGLAND.



WE ALSO OFFER CORPORATE SERVICES ACROSS THE GROUP.  
PLEASE CONTACT US FOR MORE INFORMATION.

[CORPORATEBOOKINGS@EASTWELLMANOR.CO.UK](mailto:CORPORATEBOOKINGS@EASTWELLMANOR.CO.UK) | 01233 213000 | [EASTWELLMANOR.CO.UK](http://EASTWELLMANOR.CO.UK)

EASTWELL MANOR  
CHAMPNEYS HOTEL & SPA

*Welcome*  
TO EASTWELL MANOR



# STEP INTO TRANQUILITY

ALL ORGANISATIONS NEED TO TAKE TIME TO REASSESS THEIR  
POSITION, PLAN STRATEGIES, FOCUS, AND JOIN FORCES TO  
CREATE BETTER WAYS OF DOING THINGS.

What better place to achieve objectives than at Eastwell Manor, surrounded by 500 acres of beautiful Kent countryside and steeped in royal history. When you need time and space to think, communicate and create ideas, our team will help you to deliver all that and more. From meetings, conferences, presentations, team building days

and sales incentives – whatever your requirement, at Eastwell Manor we make business a pleasure. However formal or informal you want your business event to be, our professional team of conference organisers will ensure the smooth running of your event so that you and your delegates can concentrate on the business in hand.

## CHAMPNEYS TIMELINE

- 2018 September:** Professional Collection launched with Boots International
- 2018 May:** Champneys spa at sea launches aboard Marella Explorer
- 2015:** Champneys celebrate 90th birthday with state-of-the-art Detox & Wellbeing Centre at Tring
- 2006:** Champneys first City Spa opens in Chichester
- 1996:** Forest Mere, a secluded lakeside resort in Hampshire is purchased
- 1981:** The Purdew family purchase the charming Georgian manor Henlow Grange, in Bedfordshire
- 2018 October:** Mottram Hall, one of Cheshire's finest manor houses, is welcomed to the Champneys Group
- 2018 June:** The Skincare Collection, created by therapists for spa, launches exclusively at Champneys
- 2016 November:** Eastwell Manor, a formal royal residence in Kent, becomes part of the Champneys Group
- 2011:** Champneys Collection launched with Boots International
- 2002:** The Purdew family purchase the Champneys brand
- 1990:** Springs in Leicestershire is purchased; the first purpose-built health spa in Britain
- 1925:** Champneys Tring opens as the first health spa in the UK

---

# A CORPORATE OFFERING

---

CONFERENCE DAYS AND STAYS ARE THE FOUNDATION TO WHICH A UNIQUE AND PERSONAL EXPERIENCE CAN BE CREATED FOR YOUR ORGANISATION.

---

## DAY DELEGATE PACKAGE

---

### Includes:

- Hire of meeting room
- LCD projector, screen and flip-chart
- Two-course lunch
- Homemade pastries and cakes
- Morning and afternoon coffee and tea break
- Selection of still and sparkling bottled waters
- Delegate pens and paper
- Complimentary onsite car parking
- Complimentary WIFI

## STAY DELEGATE PACKAGE

---

Includes everything listed in the Day Delegate package plus:

- Single occupancy in a standard double room in The Mews with the option to upgrade to The Manor
- Three-course dinner with coffee and petits fours
- Cooked breakfast
- Use of indoor and outdoor pools, hydrotherapy pool, Jacuzzi, steam room, sauna and spa
- Complimentary use of our gym and all weather tennis court



---

## ADDITIONAL INFORMATION

---

All meeting rooms are subject to a minimum occupancy – a supplement will be payable if your numbers are below this. All rates are inclusive of VAT. All rates are inclusive of complimentary use of Wi-Fi. Bedroom upgrades and spa treatments are available at a supplement.

For prices please contact [CorporateBookings@EastwellManor.co.uk](mailto:CorporateBookings@EastwellManor.co.uk)

# MEETING OF MINDS

BOARD MEETINGS, TEAM AWAY DAYS, STRATEGY PLANNING SESSIONS...  
ADD CLARITY AND CREATIVITY TO YOUR AGENDA WHEN YOU MEET  
AT EASTWELL MANOR.

Four remarkable rooms seating from 2-120 delegates, each flooded with light, full of heritage and instantly setting the scene; the perfect backdrop for your next meeting allowing space and time to let inspiration flow. With a focus on delicious food, our lunches and dinners are prepared by our Head Chef, plus the optional use of our luxurious spa facilities or outdoor pursuits make an event at Eastwell Manor the perfect corporate retreat to keep you motivated and inspired.



## ROOM CAPACITIES

**Rose Garden Room:** Boardroom 40 | U-Shape 30 |  
Classroom 40 | Theatre 100 | Reception 120 | Cabaret 50 |  
Banquet 80

**Bishop of Bayeux:** Boardroom 30 | U-Shape 20 |  
Classroom 25 | Theatre 70 | Reception 70 | Cabaret 25 |  
Banquet 40

**Cornwallis Suite:** Boardroom 14

**Queen Marie of Romania:** Boardroom 10 | Banquet 10



## ROOM LAYOUTS

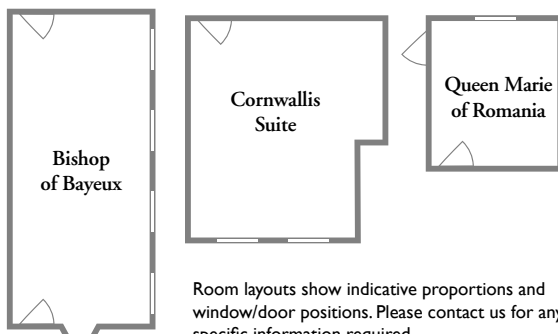
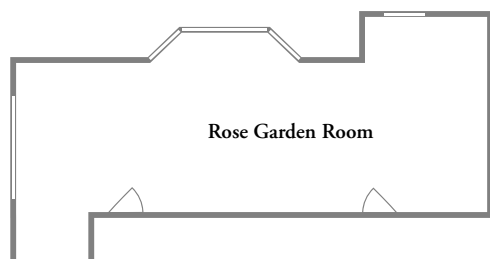

Room layouts show indicative proportions and window/door positions. Please contact us for any specific information required.

---

# PRIVATE DINING

---

EASTWELL MANOR PRIDES ITSELF ON AN OUTSTANDING RANGE OF DINING OPTIONS, CELEBRATING BRITISH HERITAGE WITH AN INTERNATIONAL INFLUENCE USING FRESH LOCALLY-SOURCED AND SEASONAL INGREDIENTS.

---

Private dining at Eastwell Manor is the perfect way to end your business day or the ideal setting to host an exclusive celebration or event. Our oak-panelled meeting spaces can all be transformed into elegant dining rooms. Whether you're looking for a relaxed afternoon tea or a fine-dining three-course meal, our chefs will prepare a menu to suit your taste.

Choose from our selection of fine wines, or try something from our extensive list of beverages including expertly made cocktails, locally produced craft beers, gins and English sparkling wines for your meal and drinks reception. Our expert and friendly events team will ensure the experience is personal to you, while making sure your event runs seamlessly from start to finish.



---

# TEAM BUILDING

---

LOOKING FOR THE IDEAL LOCATION FOR YOUR TEAM BUILDING EVENT IN KENT?  
ESCAPE THE OFFICE AND HEAD TO EASTWELL MANOR WHERE WE HAVE AMPLE SPACE  
FOR BOTH INDOOR AND OUTDOOR TEAM BUILDING ACTIVITIES.

---

## ONSITE ACTIVITIES

Our dedicated events team are happy to arrange a variety of team building activities in our stunning grounds including:

- Falconry
- Archery
- Laser clay pigeon shooting
- 9 hole golf course
- Champneys spa

*onsite*

## SPECIALIST PARTNERS

We have relationships with a number of teambuilding specialists who can bring activities onsite such as:

- Escape rooms
- Outdoor sports
- Cookery challenges
- Inflatable fun
- Drumming & musical-based experiences

*onsite*



---

# SLEEP WELL

---

WE RECOGNISE THE IMPORTANCE OF A GOOD NIGHT'S SLEEP;  
QUALITY SLUMBER IS ON OUR LIST OF PRIORITIES. SLEEP WELL,  
YOUR COMFY BED AWAITS.

---

Whether you prefer the traditional grandeur of our Manor House suites, complete with four poster beds and roll top baths, or the stylish contemporary interiors

and rainbow cottage doors of The Mews, our rooms are the perfect place for a peaceful night's sleep after a hard day's work.

